

REVISIONS				
REV	DATE	DESCRIPTION	ECO	BY
X	05-03-04	PROTOTYPE RELEASE.	-	N/A
A	06-04-04	PRODUCTION RELEASE.	11137	FJM
B	07-21-04	ADDED 050-1903, 110-0580, 120-0420 & 120-0425.	11146	FJM
C	08-19-04	MODIFIED NOTE 2.	11169	FJM
D	07-18-07	REPLACE P/N: 110-3152 WITH P/N: 110-3429.	11643	RKL

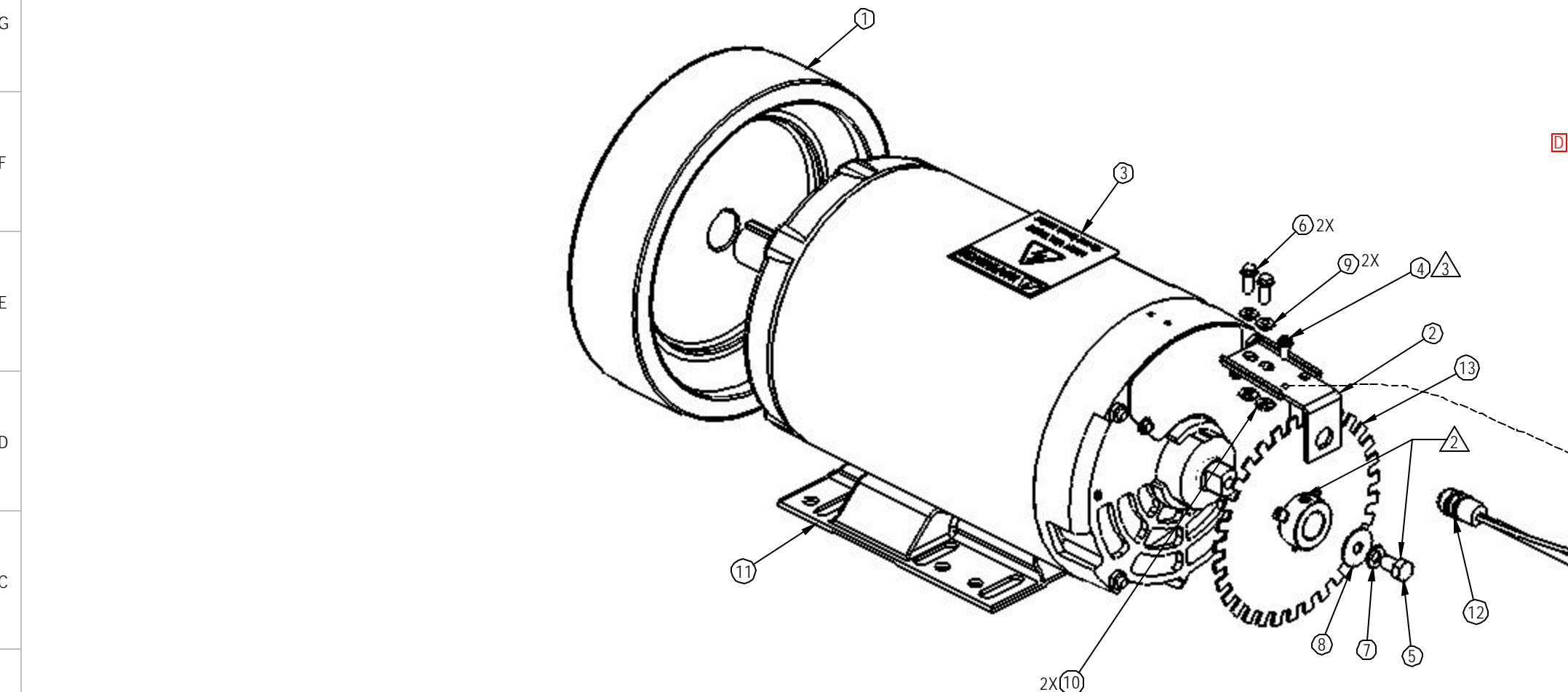

ITEM	PART NO.	DESCRIPTION	QTY
1	020-6562	PULLEY, FLYWHEEL, 220J10x.875ID	1
2	020-6563	BRACKET, RPM SENSOR, SUPPORT	1
3	050-1903	LABEL, WARNING, HIGH VOLTAGE	1
4	110-0180	SCREW, 6-32 X 3/8" HHMS,W/WASH	1
5	110-0580	SCREW, 1/4-20x 1/2" HHCS	1
6	110-3429	SCREW, 8-32 X 1/2", HHW, TAPTITE THD. FORMING, AS, ZP	2
7	120-0420	WASHER, 1/4, SPLIT LOCK	1
8	120-0425	WASHER, FLAT, 1/4 X 7/8 OD X .047	1
9	120-3266	WASHER, #8, SHOULDER, NYLON	2
10	120-3267	WASHER, #8, RETAINER, NYLON	2
11	260-0934	MOTOR, AC INDUCTION, 230V	1
12	560-0069	ASSY, GEAR TOOTH SENSOR, 6 PIN CONN.	1
13	715-3574	ASSY, RPM DISK, 31 SLOT, .625ID	1

- NOTES:
- 1 TIGHTEN SET SCREWS JUST TO KEEP PULLEY-FLYWHEEL IN PLACE.
 - 2 P/N 715-3174 INSTALLATION:
 - a) INSTALL THE RPM ASSY (715-3174) ALL THE WAY TO THE END OF THE MOTOR SHAFT.
 - b) TIGHT THE 1/4-20 SCREW (110-0580).
 - c) TIGHT THE SET SCREW ON THE RPM ASSY HUB (715-3174) TO 60-66 IN-LBS.
 - 3 USE P/N 140-0200 TO TIGHTEN HALL EFFECT CABLE & MOTOR WIRES TO THE MOTOR.

DOCUMENT STATUS:
RELEASE

NOTICE OF PROPRIETARY INFORMATION
THIS DOCUMENT SHALL NOT BE REPRODUCED NOR
SHALL THE INFORMATION CONTAINED HEREIN BE
USED BY OR DISCLOSED TO OTHER EXCEPT AS
EXPRESSLY AUTHORIZED BY UNISEN

MATERIAL	TOLERANCES UNLESS OTHERWISE SPECIFIED X.XXX = ± .010 X.XX = ± .030 X.X = ± .050 X. = ± .125		UNISEN INC. 14410 Myford Road Irvine CA 92606	
N/A	INITIAL DATE FJM 05-21-04		TITLE ASSY, MOTOR, AC INDUCTION, 230V	
FINISH	NONE		SCALE 1:3	PART NO
			SHEET 1 OF 1	B 715-3573